



ELISHA MARTI

ENJOY 2
NIGHTS IN THE
'CITY OF SPIRES',
PRAGUE



11 DAYS • 22 MEALS • BUDAPEST > PRAGUE

DANUBE DELIGHTS RIVER CRUISE

Hungary • Slovakia • Austria • Germany • the Czech Republic

Tour Dates: May 21 – 31, 2027

Discover the magic of the Danube River as you journey through five captivating countries, each rich in culture and history. Step into the past on guided walks through medieval cities, where hilltop castles, charming villages, and stunning architecture await at every turn. From vibrant, cosmopolitan capitals to storybook streets lined with cafés and boutiques, every moment offers something extraordinary. This unforgettable Danube River cruise invites you to experience it all in effortless style.



Dürnstein, Austria

DAY 1 Depart the USA

Depart the USA on your overnight flight to Budapest, Hungary.

DAY 2 Budapest, Hungary

Upon arrival, you will be met by a local representative and transferred to the ship, home for the next seven nights. The afternoon is at leisure to become acquainted with the ship or begin exploring the city on your own. This evening, join your fellow travelers for a traditional Hungarian dinner and authentic Hungarian folklore show onboard. **Meal: D**

EmeraldPLUS: Traditional Hungarian Folklore Show

DAY 3 Budapest

Today's included tour presents you with a fantastic opportunity to become acquainted with Hungary's beautiful capital. See the Hungarian Parliament Building, Heroes' Square, and Andrassy Avenue – a UNESCO World Heritage Site. Alternatively, enjoy a guided hike to Gellert Hill for a postcard-worthy panorama of the Danube banks. This afternoon, the ship departs for Bratislava. **Meals: B, L, D**

EmeraldACTIVE: Guided Hike to Gellert Hill



Bratislava Castle, Slovakia

DAY 4 Bratislava, Slovakia

This morning, relax onboard as the ship sails to Bratislava. Witness Bratislava Castle, perched atop a hill, as you arrive into port. During the guided walking tour, meander through the heart of the city as you view the lavish Episcopal Summer Palace, the neo-Renaissance façade of the Slovak National Theater, and charming streets lined with quaint shops and cafés. Alternatively, choose to join the hike to the castle for a look around the gardens and overview of the Danube. This afternoon, a highlight of the day will be a home-hosted visit where you are treated to tasty homemade specialties in the home of local Slovaks. What a unique opportunity to meet the locals and learn about life in Slovakia! **Meals: B, L, D**

EmeraldACTIVE: Guided Hike to Bratislava Castle

DiscoverMORE: Carpathian Wine Route (extra expense)

DiscoverMORE: Skoda Tour of Post-Communist Bratislava (extra expense)

EmeraldPLUS: Home hosted coffee and cake with a Slovakian Family

DAY 5 Vienna, Austria

Welcome to Vienna, the capital of classical music and world-famous art exhibitions. Today you have a choice of activities: explore Austria's art history on an included tour featuring a visit to the Kunsthistorisches Museum, the largest art museum in the country and one of the most important museums in the world. OR, explore on two wheels with a bike ride along the river, arriving at Danube Island. **Meals: B, L, D**

EmeraldACTIVE: Guided Bike Tour of Vienna

DiscoverMORE: Exclusive Viennese Concert (extra expense)

DAY 6 Dürnstein

This morning sail along the river and through the UNESCO World Heritage Wachau Valley en route to Dürnstein. Enjoy time at leisure in this charming village, known as "The Pearl of the Wachau Valley". This afternoon, depart on a guided tour of Gottweig Abbey, one of Austria's most important Benedictine abbeys. Sitting atop a hill near Krems, this architectural treasure overlooks the UNESCO World Heritage Wachau Valley. Alternatively, cycle past the terraced vineyards and castles as you join a guided bike tour. **Meals: B, L, D**

EmeraldACTIVE: Guided Bike Tour along the Danube River

EmeraldACTIVE: A guided hike to Durnstein Castle

EmeraldPLUS: Tour of Gottweig Abbey

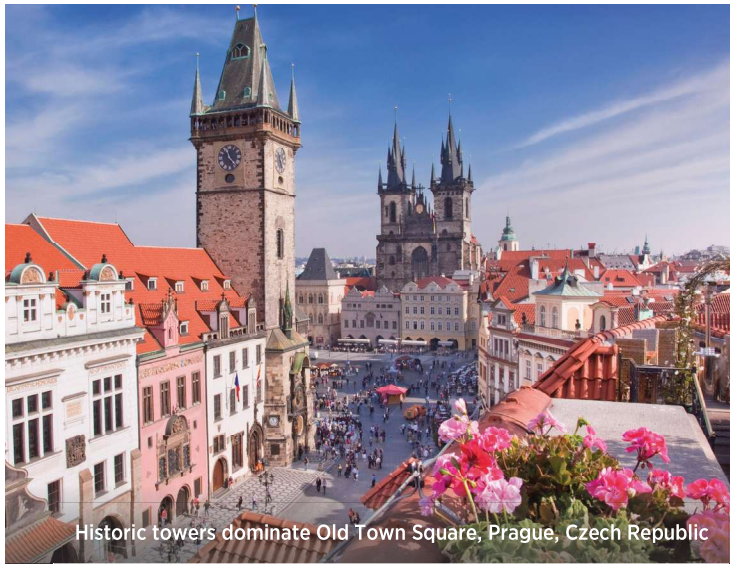

Historic towers dominate Old Town Square, Prague, Czech Republic

DAY 7 Passau, Germany

After a relaxing morning onboard, the ship arrives in Passau where cobblestone streets and graceful arcades welcome you. On an included walking tour of this city on the confluence of the Danube, Inn and Ilz Rivers, stroll through the old town's narrow alleyways and see its noteworthy architecture. St. Stephen's Cathedral is a wonderful example of Baroque architecture and home to Europe's largest pipe organ with more than 17,000 pipes. After a bit of free time, return to the ship for a leisurely sailing along the river to Regensburg.

Meals: B, L, D

EmeraldACTIVE: Guided Bike Tour along the River Inn

DAY 8 Regensburg

A morning arrival in Regensburg brings you to one of Germany's best-preserved medieval cities and home to one of the oldest bridges crossing the Danube. As a local guide leads you through cobblestone lanes on a walking tour, discover the UNESCO World Heritage city center and see many of the city's architectural highlights. Enjoy a Bavarian sausage tasting during the tour for a real 'taste' of local life! Alternatively, join a bike tour to the Walhalla Monument, towering high above the slopes of the Danube. The site affords a fascinating view of the surrounding landscape and the river below. This evening, a traditional Bavarian band performs onboard. The ship remains docked in Regensburg overnight. Meals: B, L, D

EmeraldPLUS: Walking Tour of Regensburg

EmeraldACTIVE: Guided Bike Tour to Walhalla Monument

EmeraldPLUS: Traditional Bavarian Band onboard

DAY 9 Regensburg – Prague, Czech Republic

After breakfast, say goodbye to your Captain and crew as you disembark your ship and depart by motorcoach for Prague, Czech Republic. This afternoon is at your leisure to continue your independent exploration. Meal: B

DAY 10 Prague

Enjoy an included city tour highlighting the famous sites of this beautiful city. The heart of the city is discovered on foot. See Old Town Square with its historic astronomical clock, and the medieval Charles Bridge or perhaps join the DiscoverMORE Terezin Concentration Camp. The tour concludes at the hotel with the evening at leisure. Meal: B

DiscoverMORE: Terezin Concentration Camp (extra expense)



EXCEPTIONAL INCLUSIONS

- 22 Meals: 9 breakfasts, 6 lunches, and 7 dinners
- Airport transfers on tour dates when air is provided by Mayflower Cruises & Tours
- Visit five countries
- Seven-night cruise in a suite or stateroom of your choice onboard the vessel
- All gratuities included
- First-class service by an English-speaking crew
- Onboard Activity Manager will support all EmeraldACTIVE excursions and host daily onboard wellness activities, games, classes and evening entertainment
- Shore excursions with English-speaking local guides
- Personal listening device for excursions
- All meals included onboard with a variety of international cuisine
- Complimentary regional wines, beer and soft drinks accompany onboard lunches and dinners
- Complimentary bottled water in your stateroom
- Complimentary WiFi onboard
- Complimentary bicycles onboard for use ashore
- All port charges included
- Two-night hotel stay and touring in Prague, Czech Republic

DAY 11 Prague / USA

Bid a fond farewell to Europe and return home with wonderful memories of life-enriching experiences from your cruise along the Danube River. Meal: B

Itinerary and excursions are subject to change.

CRUISE AND HOTEL ACCOMMODATIONS

Days 2 through 8 – aboard an Emerald Cruises Star-ship

Days 9 and 10 – Grandium Hotel, or similar, Prague, Czech Republic

EMERALD STAR-SHIPS

Built: 2014-2026 Cabins: 91 Guests: 180 Length: 443 ft. Crew: 52

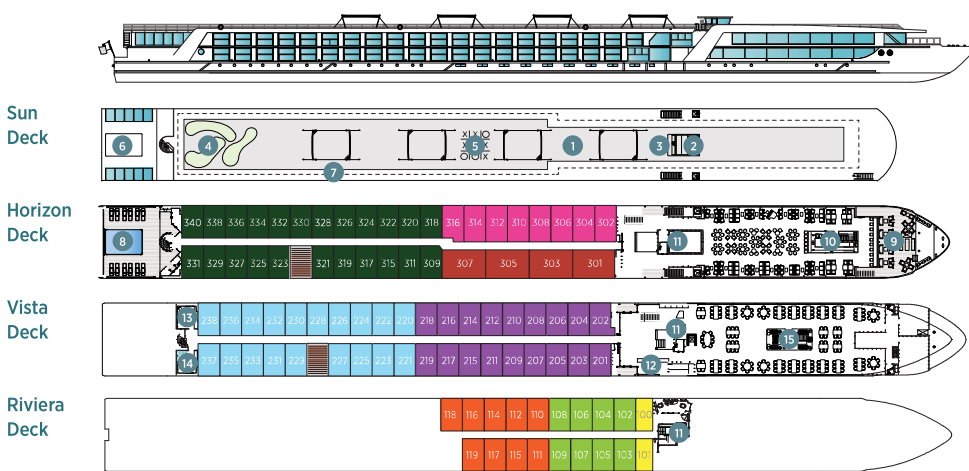

- 1 Sun Deck with Deck Chairs*
- 2 Navigation Bridge
- 3 Sky Barbecue
- 4 Golf Putting Green
- 5 Games Area
- 6 Retractable Glass Roof
- 7 Walking Track
- 8 Daytime Pool & Bar/Evening Cinema
- 9 The Terrace
- 10 Horizon Bar & Lounge
- 11 Lift
- 12 Reception
- 13 Wellness Area
- 14 Fitness Area
- 15 Reflections Restaurant

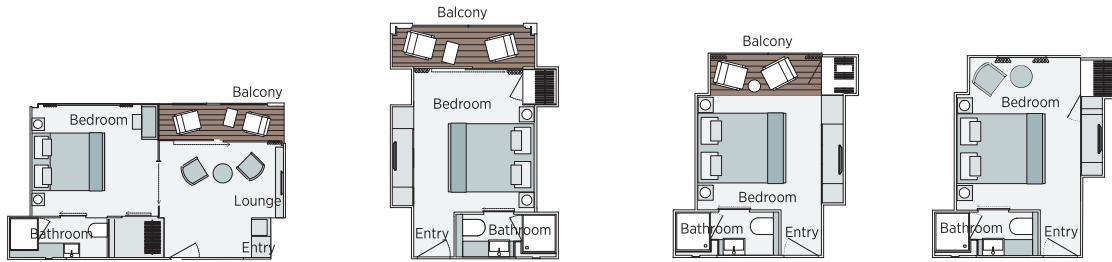

Owner's One-Bedroom Suite
285ft² – 315ft²

CAT SA

Grand Balcony Suite
207ft² – 210ft²

CAT S

Emerald Panorama Balcony Suite
160ft² – 189ft²

CAT A CAT B CAT C

Emerald Stateroom
153ft² – 170ft²

CAT D CAT E

Important Information: The cabin and deck plans, sizes and photographs are an indication only and are subject to variation. * Due to safety, the Sun Deck will be closed when travelling under low bridges.

Tour Code 822PC 2027 Departure Date	RIVIERA DECK		VISTA DECK		HORIZON DECK		HORIZON DECK		HORIZON DECK	
	CAT E, D		CAT C, B		CAT A		CAT S		CAT SA	
	Emerald Stateroom		Panorama Balcony Suite		Panorama Balcony Suite		Grand Balcony Suite		Owner's One-Bedroom Suite	
	PER PERSON TWIN	SINGLE ROOM	PER PERSON TWIN	SINGLE ROOM	PER PERSON TWIN	SINGLE ROOM	PER PERSON TWIN	SINGLE ROOM	PER PERSON TWIN	SINGLE ROOM
May 21	\$6,099	+ \$4,358	\$7,064	+ \$5,081	\$7,339	+ \$5,288	\$8,332	N/A	\$9,544	N/A

Pricing includes Local Lansing pickup (w/10), roundtrip MSP airfare, port charges, hotel baggage transfers, 22 meals, wine and beer with lunches and dinners on ship, gratuities to guides, drivers and ship staff and hosted by Elisha!

Deposit amount will be \$400 per person and final payment is January 10, 2027.

Air itineraries may not be available until documents are received. Air seats are assigned by the airline for the entire group and may not be available until airport check-in. Seat changes can only be attempted at the airport and may not be possible. If specific seat assignments are vital to your reservation, we recommend booking air on your own rather than booking air with the group.

Passport required on this program



Travelers Protection Plan (TPP) for River Cruises – \$569 per person (optional)

This nonrefundable fee will provide a refund to you during the instance that you have to cancel your trip. The cancellation has to be for a covered reason (see Plan for details on coverage) and we have to be notified at least one day prior to departure. If you must leave the tour early due to personal illness or the illness or death of an immediate family member, TPP will provide a refund for any unused services after the departure of the tour. Other benefits include medical expenses for illness and injury, emergency transportation, 24 hour hot line and lost or stolen baggage assistance. Return air transportation is included ONLY if your air tickets are purchased through Mayflower Cruises & Tours. Please review the Plan for details on coverage. Should you choose not to purchase our TPP, the following per person cancellation charges will be assessed for all tours and optional excursion costs:

- 121 days or more prior to departure: Deposit Amount
- 120 days to day of departure: 100% of total tour
- No refund on unused portions of the tour

Exclusions: Mayflower Cruises & Tours reserves the right to alter its Refund and Cancellation Policy when a substantial amount of cancellation or postponement of travel is attributable to: conditions resulting from an act of God, natural or man-made disaster, fire, government action, civil disorder, war, hostilities between nations, or unavailability of transportation through no fault of Mayflower Cruises & Tours. Plan and benefits offered and administered by Trip Mate, Inc.

FOR RESERVATIONS OR INFORMATION CONTACT:



Elisha Marti at 563-538-0378
emarti@kerndtbrothers.com

